

Owner Manual with Parts List

Bolens M456 01 **Dump Cart**

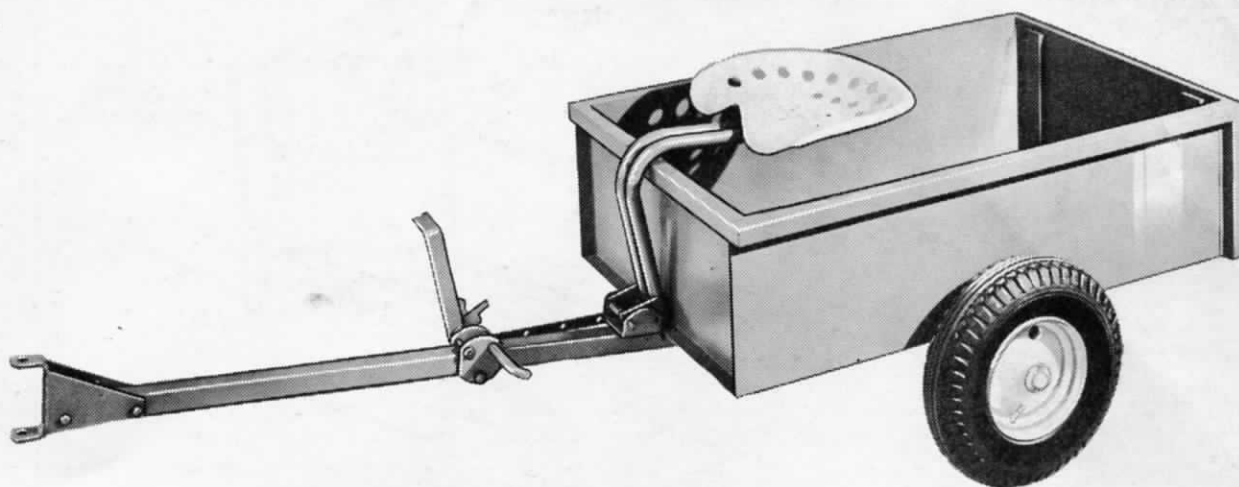

The M456 Dump Cart is shipped from the factory in one carton and one bundle. The carton contains the box, wheels, axle, brakes, foot rest, seat bracket, etc., and the bundle consists of the main tongue assembly. The foot rest and brake parts are assembled as a separate unit for easy installation.

Slide the foot rest assembly over the long tongue from the front until the extended brake bar is approximately four inches from the rear of the tongue. When installing this assembly the upright foot pedal (19) should be on the right hand side and the brake link to the rear.

Position the axle assembly over the rear of the tongue and secure with 3/8-16 x 2-1/2 inch cap screws. Insert the brake bar (9) through the front slotted hole of the brake support on the left side of axle assembly and then through the holes in the fins of the axle. Place the brake clip (4) which is attached to the brake linkage over this brake bar and bring the entire bar assembly through the brace on the right end of axle assembly so it extends through slotted hole on right side of brake support.

Two brake shoes are furnished with the dump cart assembly. Place one shoe on each end of the brake rod with the curved surface toward the front. The brake shoes will remain in a floating position and are held in place by the wheels.

Install the wheel assemblies to each end of the axle. Insert flat washer and secure with 3/16 x 1-3/4 inch cotter pins.

Install spring (11) from the hole in fin brace of axle to the cotter pin in the brake link. Position

the foot rest assembly on the tongue so that when the foot pedal is pressed downward, the brake shoes contact the wheels. Tighten cap screws.

Install the seat bracket by placing the lower end of this assembly between the welded upright brackets on the tongue assembly. Install the hinge latch rod (24) by inserting this rod through the front holes of the brackets from the right hand side. Before extending rod through both sides of the bracket, insert spring (23) over the rod so that the spring is between the two upright brackets. Compress spring so that cotter pin can be applied in hole provided in rod. Attach the seat to seat mounting assembly with seat clamp and 1/2-13 x 2 inch carriage bolt provided. The seat can be positioned on the seat bracket assembly in any position desired by the operator.

Release latch rod (24) by pulling rod outward to disengage from bracket and tilt seat assembly forward. With the seat assembly in the forward position mount the box on the axle assembly so that the center box clips rest on the axle. To hold the box in a horizontal position on the main frame assembly, return the seat to its original position and lock the entire assembly with the latch rod.

Attach the front hitch assembly (16) to the tongue extension with 3/8-16 x 2-1/2 inch cap screws. Reference number (21) is a brake pedal latch for locking the brakes. To lock the brakes, it is only necessary to press forward on the upright brake pedal and then by hand turn the latch to the rear so that it catches on the bracket assembly. To release brake, lift up latch and allow entire brake



BOLENS PRODUCTS DIVISION

Food Machinery and Chemical Corporation

Port Washington, Wisconsin, U. S. A.

mechanism to release. When front mounted attachments are used, such as lawn mower, cart, etc., install front cap screw only. This allows cart to swivel so attachments will follow the contour of the ground.

For installation of the M456 Dump Cart Assembly

to a 15F Series Tractor, it is necessary to first install hitch assembly number F130 to the tractor. For attaching to the 12B, 12BA or 12BB, hitch assembly A130B is necessary.

For attaching the M456 to a Gardener tractor, it is necessary to first install hitch BR130 to the tractor.

Box capacity 7cu. ft.
1000 lbs.

Overall L. 88-1/2 in.
H. 22-1/2 in.
W. 35 in.

Box inside L. 41-3/4 in.
H. 12 in.
W. 26 in.



Nameplate

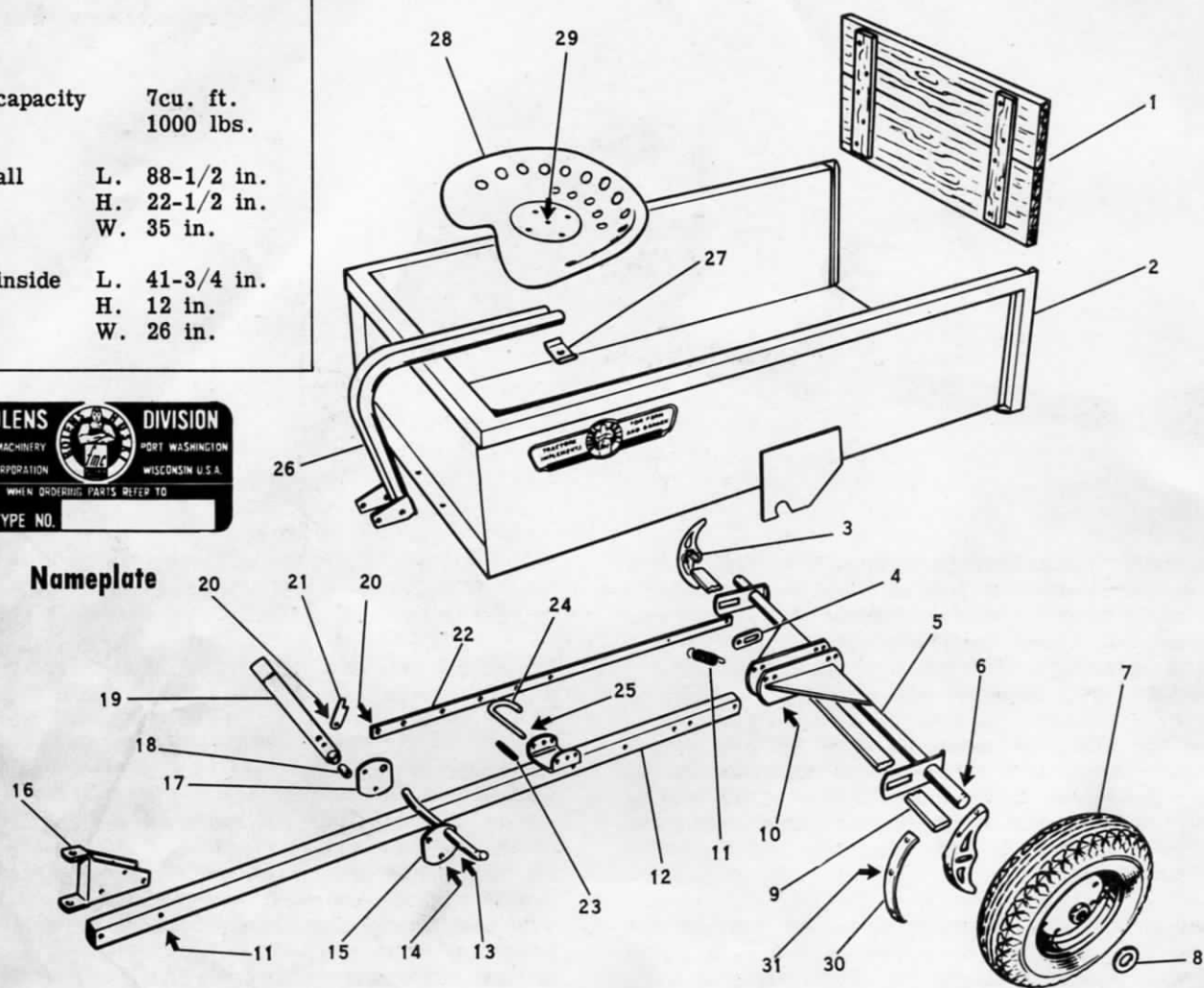

Ref. No.	Part No.	Description	No. Req'd.
1	1701634	End Gate	1
2	1701633	Dump Body (Less End Gate)	1
3	1702668	Brake Shoe Assy (w/Lining)	2
4	1701618	Brake Clip	1
5	1701624	Axle Assembly	1
6		Cotter Pin, 3/16 x 1-3/4	2
7	1701668	Wheel & Tire Assembly	2
8		Flat Washer, 1"	2
9	1701617	Brake Bar	1
10		Capscrew, 3/8-16 x 2-1/2	4
11	1701322	Spring	1
12	1701636	Tongue	1
13		Capscrew, 3/8-16 x 2-1/2	1
14		Capscrew, 3/8-16 x 3-1/2	1
15	1701615	Foot Rest	1
16	1701606	Hitch	1

Ref. No.	Part No.	Description	No. Req'd.
17	1701613	Foot Rest Support	1
18	1701608	Pedal Sleeve	1
19	1701611	Brake Pedal	1
20		Capscrew, 3/8-16 x 7/8	3
21	1701607	Brake Latch	1
22	1701612	Brake Link	1
23	1700052	Spring	1
24	1701601	Seat Hinge Latch	1
25		Cotter Pin, 3/32 x 3/4	1
26	1702423	Seat Bracket	1
27	1702427	Seat Clamp	1
28	1700367	Seat	1
29		Carriage Bolt, 1/2-13 x 2	1
30	1702665	Brake Lining Only	2
31	1185185	Brake Rivet	8

NOTE: Nuts and bolts are standard size and can be obtained from your Hardware or Implement dealer.
Form No. 550406-2

PREPARED BY KEN COOK CO MILWAUKEE

KENCO-LITHO U.S.A.

Bolens Products Division



Owner Manual WITH Parts List

Bolens DUMP CART

TYPE M456 01

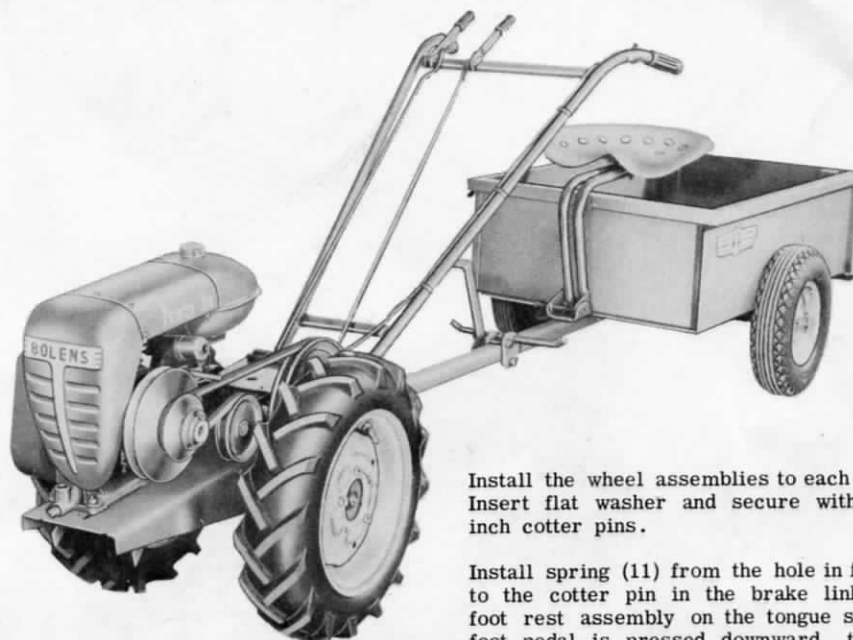

The M456 Dump Cart is shipped from the factory in one carton and one bundle. The carton contains the box, wheels, axle, brakes, foot rest, seat bracket, etc., and the bundle consists of the main tongue assembly. The foot rest and brake parts are assembled as a separate unit for easy installation.

Slide the foot rest assembly over the long tongue from the front until the extended brake bar is approximately four inches from the rear of the tongue. When installing this assembly the upright foot pedal (7) should be on the right hand side and the brake link to the rear.

Position the axle assembly over the rear of the tongue and secure with 3/8-16 x 2-1/2 inch cap screws. Insert the brake bar (9) through the front slotted hole of the brake support on the left side of axle assembly and then through the holes in the fins of the axle. Place the brake clip (4) which is attached to the brake linkage over this brake bar and bring the entire bar assembly through the brace on the right end of axle assembly so it extends through slotted hole on right side of brake support.

Two brake shoes are furnished with the dump cart assembly. Place one shoe on each end of the brake rod with the curved surface toward the front. The brake shoes will remain in a floating position and are held in place by the wheels.

Install the wheel assemblies to each end of the axle. Insert flat washer and secure with 3/16 x 1-3/4 inch cotter pins.

Install spring (11) from the hole in fin brace of axle to the cotter pin in the brake link. Position the foot rest assembly on the tongue so that when the foot pedal is pressed downward, the brake shoes contact the wheels. Tighten cap screws.

Install the seat bracket by placing the lower end of this assembly between the welded upright brackets on the tongue assembly. Install the hinge latch rod (24) by inserting this rod through the front holes of the brackets from the right hand side. Before extending rod through both sides of the bracket, insert spring (23) over the rod so that the spring is between the two upright brackets. Compress spring so that cotter pin can be applied in hole provided in rod. Attach the seat to seat mounting assembly with seat clamp and 1/2-13 x 2 inch carriage bolt provided. The seat can be positioned on the seat bracket assembly in any position desired by the operator.

Release latch rod (24) by pulling rod outward to disengage from bracket and tilt seat assembly forward. With the seat assembly in the forward position mount the box on the axle assembly so that the center box clips rest on the axle. To hold the box in a horizontal position on the main frame assembly, return the seat to its original position and lock the entire assembly with the latch rod.

Attach the front hitch assembly (16) to the tongue extension with 3/8-16 x 2-1/2 inch cap screws. Reference number 21 is a brake pedal latch for locking the brakes. To lock the brakes, it is only necessary to press forward on the upright brake

Bolens Products Division

**FOOD MACHINERY AND CHEMICAL CORPORATION
PORT WASHINGTON, WISCONSIN**

pedal and then by hand turn the latch to the rear so that it catches on the bracket assembly. To release brake, lift up latch and allow entire brake mechanism to release.

For installation of the M456 Dump Cart Assembly

to a 12B, 12BA or 12BB Power-Ho, it is necessary to first install hitch assembly number A-130B to the tractor.

For attaching the M456 to a Gardener tractor, it is necessary to first install hitch BR130 to the tractor.

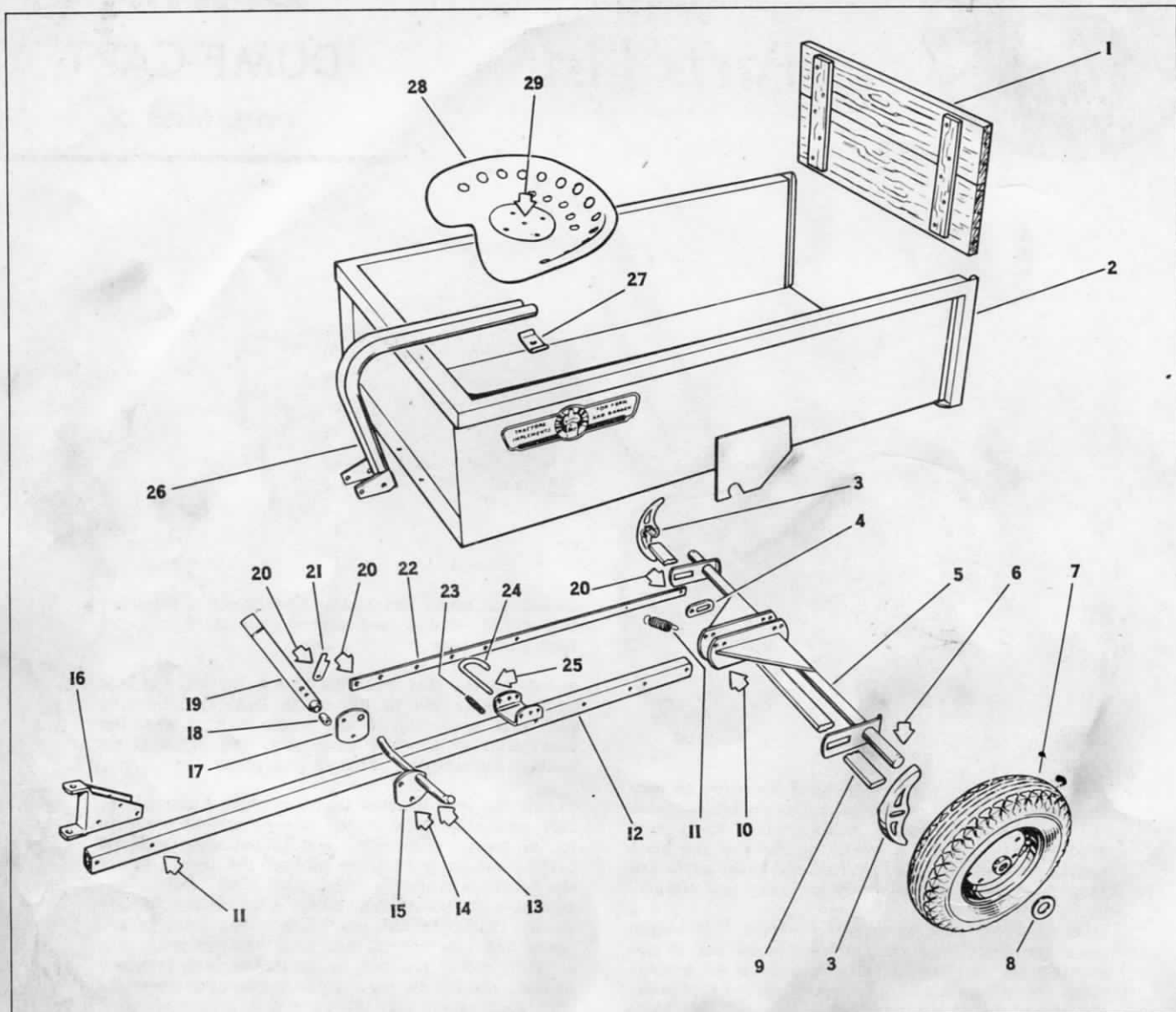

Ref. No.	Part No.	Description	No. Req'd.
1	1701634	End Gate	1
2	1701633	Dump Body (Less End Gate)	1
3	1701619	Brake Shoe	2
4	1701618	Brake Clip	1
5	1701624	Axle Assembly	1
6		Cotter Pin, 3/16 x 1-3/4	2
7	1701668	Wheel & Tire Assembly	2
8		Flat Washer, 1"	2
9	1701617	Brake Bar	1
10		Cap screw, 3/8-16 x 2-1/2	4
11	1701322	Spring	1
12	1701636	Tongue	1
13		Cap screw, 3/8-16 x 2-1/2	1
14		Cap screw, 3/8-16 x 3-1/2	1
15	1701615	Foot Rest	1

Ref. No.	Part No.	Description	No. Req'd.
16	1701606	Hitch	1
17	1701613	Foot Rest Support	1
18	1701608	Pedal Sleeve	1
19	1701611	Brake Pedal	1
20		Cap screw, 3/8-16 x 7/8	3
21	1701607	Brake Latch	1
22	1701612	Brake Link	1
23	1700052	Spring	1
24	1701601	Seat Hinge Latch	1
25		Cotter Pin, 3/32 x 3/4	1
26	1702423	Seat Bracket	1
27	1702427	Seat Clamp	1
28	1700367	Seat	1
29		Carriage Bolt, 1/2-13 x 2	1

NOTE: Nuts and bolts are standard sizes and can be obtained from your Hardware or Implement dealer.

Form No. 550406

Bolens Products Division

Ken Cook Milwaukee