

INSTALLATION INSTRUCTIONS

**ONE POINT HITCH
MFG. NO. 1600055**

The one point hitch assembly, when properly attached to the tractor, is used to attach the plow and any other implements designed to meet the A.S.A.E. one point sleeve hitch standards.

ASSEMBLY

See Figures 1 and 2 to identify kit components.

1. Attach the hitch assembly to tractor drawbar with attaching pins (K, Figure 2) and hairpin clips (J). The longest section of sleeve on hitch assembly (A) should face downward.
2. Assemble lift rod (D), jam nut (F) and yoke end (G), as shown in Figure 1. Adjust yoke to obtain a 8-1/2 inch dimension between center of pin hole in yoke and center of the opposite end of lift rod.
3. Attach adjusted lift rod between hitch assembly and rear lift assembly with yoke end down. Be sure to place a flat washer (E, Figure 2) on upper end of lift rod before installing hairpin clip (J). See Figure 2.
4. Place hitch pin (I) into sleeve. Secure with hairpin clip (J).

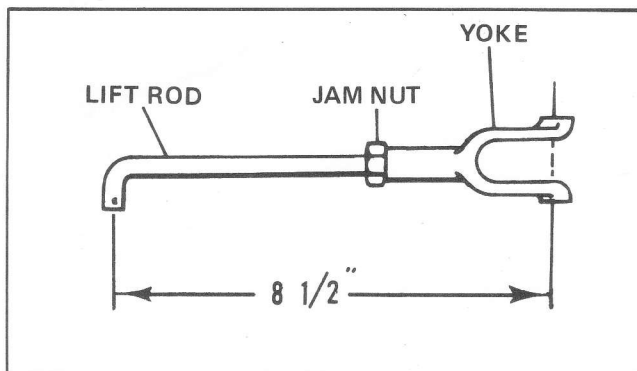

Figure 1. Lift Rod and Yoke Assembly

ADJUSTMENT

The Antisway bolts (B) can be adjusted using jam nuts (C) to prevent or limit implement side sway when turning and while transporting. However, they should not be adjusted out to a point where it will interfere with the normal operation of the implement. The plow for instance should be free to follow tractor around obstacles such as bushes and trees while plowing and not interfere with steering of tractor. Therefore, the antisway bolts will have to be re-adjusted for various implements and conditions.

NOTE

A special sway bracket (H) is provided for use only with implements with a clevis too narrow to contact the antisway bolts.

OPERATION

Normally all implements using the one point sleeve hitch would be operated in a floating position for best results. This means that with a manual lift tractor the lift handle would be farther forward than necessary. With an electric lift tractor, the lift actuator would be run out slightly farther than what is necessary to obtain implement operating position. This would provide slack in rear lift cable permitting upward and downward float.

ACCESSORIES

It is recommended that optional front wheel weights be added to tractor when using heavy drawbar load implements such as the plow.

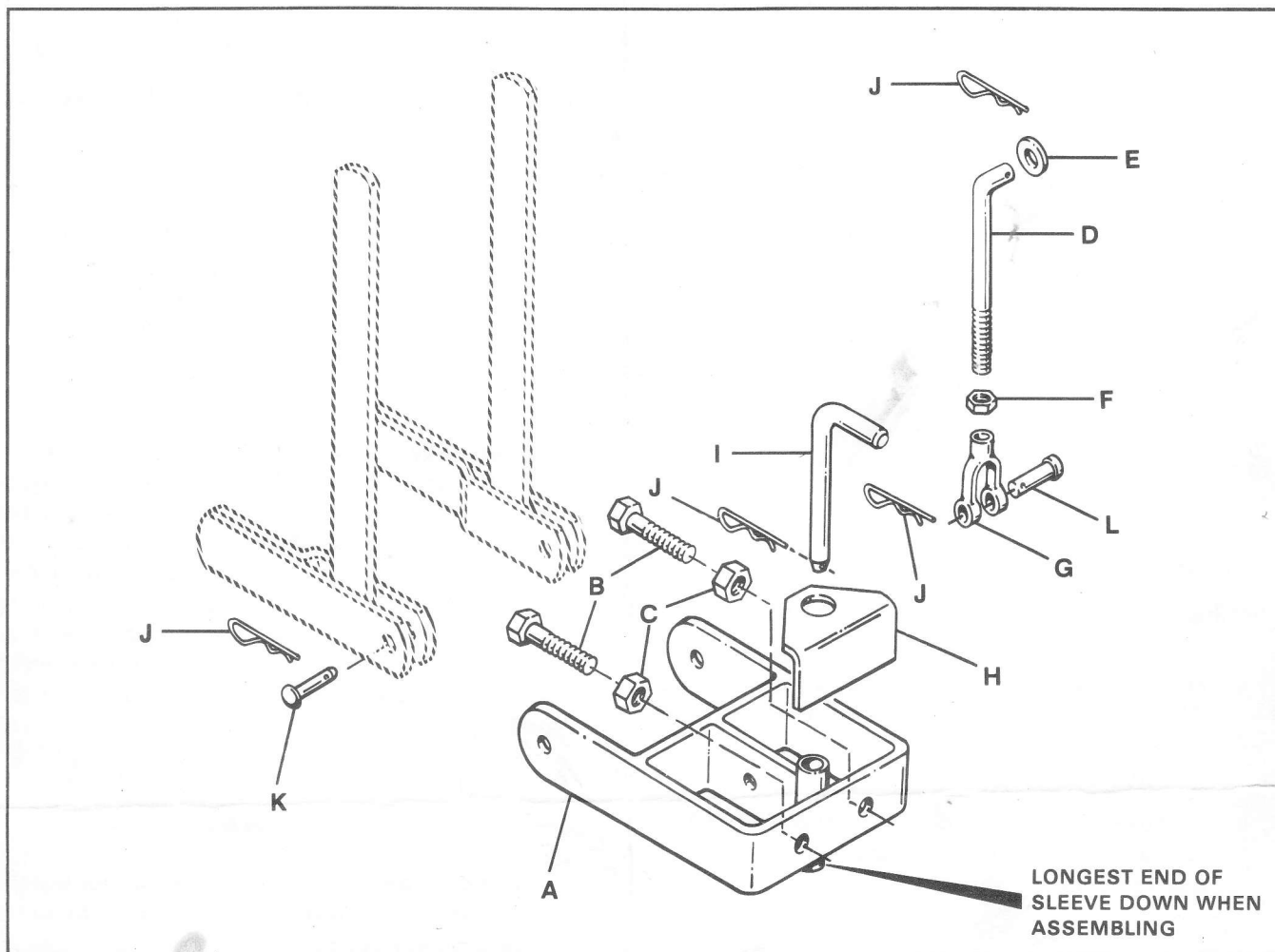

Figure 2. One Point Hitch Assembly

- A. HITCH ASSEMBLY
- B. CAPSCREW, Hex Hd., 5/8 x 2-1/4
- C. NUT, Hex Jam, 5/8
- D. LIFT ROD
- E. WASHER, Plain, 1/2 x 1-1/4
- F. NUT, Hex Jam, 1/2
- G. YOKE END, Adj.
- H. BRACKET, Sway
- I. PIN, Hitch
- J. CLIP, Hairpin
- K. PIN, Round Head
- L. PIN, Yoke